

Vectra 3D[®] for Dogs

Over 95 lbs, over 8 weeks of age

AVAILABLE FROM LICENSED VETERINARIANS

- ▼ Repels and kills fleas, ticks and mosquitoes
- ▼ Repels ticks before they can attach to dogs
- ▼ Begins reducing flea feeding in 5 minutes
- ▼ Kills mosquitoes before they bite
- ▼ Repels and kills lice
- ▼ Kills the vectors that may transmit Lyme disease, Rocky Mountain spotted fever, babesiosis, ehrlichiosis, bartonellosis, hepatoozoonosis, leishmaniasis and heartworm disease



ACTIVE INGREDIENTS:

Dinotefuran	4.95%
Pyriproxyfen	0.44%
Permethrin	36.08%
OTHER INGREDIENTS	58.53%
TOTAL	100.00%

- ▼ Repels and kills Brown dog ticks (*Rhipicephalus spp.*), Deer ticks (*Ixodes spp.*), American dog ticks (*Dermacentor variabilis*), Lone Star ticks (*Amblyomma americanum*) and Gulf Coast ticks (*Amblyomma maculatum*) for one month
- ▼ Limited flea feeding reduces likelihood of anemia, irritation, flea allergy dermatitis and transmission of disease
- ▼ Remains effective after bathing and swimming 24 hours after application
- ▼ Formulated for dogs that love the outdoors

KEEP OUT OF REACH OF CHILDREN WARNING

READ ENTIRE LABEL BEFORE EACH USE
USE ONLY ON DOGS AND PUPPIES 8 WEEKS
OF AGE OR OLDER WEIGHING over 95 LBS.

FOR ADDITIONAL INFORMATION, CONTACT US AT 1-800-999-0297 or contact.us@ceva.com

FIRST AID

If in eyes:	Hold eye open and rinse slowly and gently with water for 15-20 minutes. Remove contact lenses, if present, after the first 5 minutes, and then continue rinsing. Call a poison control center or doctor for treatment advice.
If swallowed:	Call a poison control center or doctor for treatment advice. Have the person sip a glass of water if able to swallow. Do not induce vomiting unless told to do so by a poison control center or doctor. Do not give anything by mouth to an unconscious person.
If on skin or clothing:	Take off contaminated clothing. Rinse skin immediately with plenty of water for 15-20 minutes. If skin appears irritated after rinsing call a poison control center or doctor, or 1-800-999-0297 immediately for treatment advice.

Have the product container or label with you when calling a poison control center or doctor or going for treatment. You may contact 1-800-999-0297 for emergency medical information.

PRECAUTIONARY STATEMENTS

HAZARDS TO HUMANS:

WARNING: Causes substantial but temporary eye injury. Harmful if swallowed or absorbed through skin. Do not get in eyes or on clothing. Avoid contact with skin. Remove and wash contaminated clothing before reuse. Wash thoroughly with soap and water after handling and before eating, drinking, chewing gum, using tobacco products, or using the toilet.

HAZARDS TO DOMESTIC ANIMALS:

For external use on dogs only. Certain medications can interact with pesticides. Do not use this product on debilitated, aged, medicated, pregnant or nursing dogs or dogs with known organ dysfunction without first consulting a veterinarian. If your dog is exhibiting signs of and/or is being treated for skin dermatitis, talk to your veterinarian before applying any topical flea and tick control. This product is not a substitute for a prescribed heartworm preventive. Consult a veterinarian for treatment advice.

SIDE EFFECTS:

Monitor your dog after application. Individual sensitivity, such as slight transitory redness, erythema, itching (pruritus) or other signs of discomfort at the site of application, may occur after using ANY pesticide product for dogs. If signs of sensitivity occur, bathe your dog with mild soap or shampoo and rinse with large amounts of water. If signs of individual animal sensitivity occur and persist, contact your veterinarian. Gastrointestinal signs such as vomiting or diarrhea have also been reported. If these signs occur, consult your veterinarian or call us at 1-800-999-0297. Have the product container or label with you when calling your veterinarian for advice.



DO NOT USE ON CATS - MAY BE FATAL

Due to their unique physiology and inability to metabolize certain compounds, this product must not be used on cats. Keep cats away from treated dogs for 24 hours. If applied to a cat, or ingested by a cat that actively grooms a recently treated dog, contact your veterinarian immediately.



Datamatrix code (5mm x 5mm)
requires 5mm of clearance
on all sides (total of 15mm x 15mm)

7/8" / 22.225 mm

1" / 25.4 mm

1" / 25.4 mm

1" / 25.4 mm

1" / 25.4 mm

1" / 25.4 mm

1" / 25.4 mm

1" / 25.4 mm

1" / 25.4 mm

8-7/8" / 225.425 mm

DIRECTIONS FOR USE

It is a violation of Federal law to use this product in a manner inconsistent with its labeling.

RESTRICTIONS:

- Do not use on cats or other animals.
- Do not allow children to apply product.
- Do not have contact or allow children to have contact with treated areas until treatment is completely dry.
- Do not apply more than one tube per treatment for one dog regardless of the dog's weight.
- Do not treat your dog with more than one pesticide product at a time. Overdosing your dog can result in serious illness and even death.
- Do not apply more than once per month.
- Do not bathe or allow your dog to swim within 24 hours of application.
- Do not get the product in the dog's eyes or mouth.
- Do not allow your dog to ingest this product.
- Do not use on dogs and puppies less than 8 weeks of age and under 95 lbs.

HOW TO APPLY:

- Ensure your dog is dry before applying the product, and ensure your dog remains dry for 24 hours after application. The dog should be standing while the product is applied. Application of product on dogs must only be done indoors.
- Remove applicator tube from package.
- Holding the applicator tube upright, pointing away from you and your dog's face, place your thumb and index finger around the applicator tip under the large disk. With the other hand, grasp the stem of the applicator tip above the smaller disk. Press down firmly on the small disk until both disks meet, piercing the seal. (See illustration.)
- Using the applicator tip, part the hair at the base of the tail, and begin applying the product onto the skin in a continuous line from the base of the tail along the center of the back all the way up to the shoulder blades, as shown in the diagram, squeezing the applicator tube until it's empty. Avoid superficial application to the dog's hair.
- Discard the empty applicator tube as outlined in the Storage and Disposal section.
- Repeat every month.
- For continuous control and prevention of adult and immature flea stages, ticks, mosquitoes, lice, mites (excluding mange mites), biting flies, and sand flies, apply product monthly year-round.

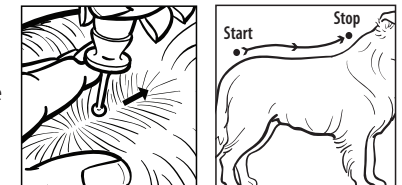
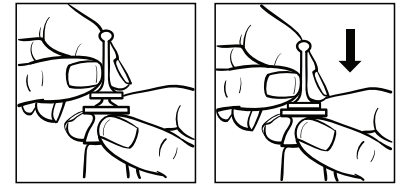

STORAGE AND DISPOSAL

Do not contaminate water, food or feed by storage or disposal.

PESTICIDE STORAGE: Store in a cool, dry place. Protect from freezing. KEEP OUT OF REACH OF CHILDREN.

PESTICIDE DISPOSAL AND CONTAINER HANDLING: Non-refillable container. Do not reuse or refill this container. **If empty:** Place in trash or offer for recycling, if available. **If partially filled:** Do not pour or dispose of down the drain or sewer. Call your local solid waste agency for disposal options.

LIMITED WARRANTY AND LIMITATION OF DAMAGES

Seller warrants that the material conforms to the chemical parameters of the US EPA registration and the label. To the extent consistent with applicable law, seller makes no warranty, express or implied, other than indicated on the label. Buyer and user assume all risk of use and handling of this material. To the extent consistent with applicable law, any damages arising from use of this product or a breach of this warranty shall be limited to direct damages and shall not include consequential or incidental damages such as loss of profit or values.

***Satisfaction Guarantee.** We want you to be happy with any Vectra[®] product you purchase. If you decide this Vectra[®] product is not the right solution for your pet, you may return it accompanied by your proof of purchase to the original place of purchase within 60 days.

EPA Reg. No. 83399-6
EPA Est. No. 91645-FL-1

©2023 Ceva Animal Health, LLC
D73840B-US / 08-A1-v6

Vectra 3D Logo is a registered trademark of Ceva Animal Health, LLC.
706531



Manufactured for:
Ceva Animal Health, LLC
8735 Rosehill Road
Lenexa, KS 66215



*Or your money back.